

### Flange speciali B5 per grandezze motori

### Possible special flange combinations B5

### Flasques speciales B5 pour taille moteur

### Mögliche spezial Flansch Kombinationen B5

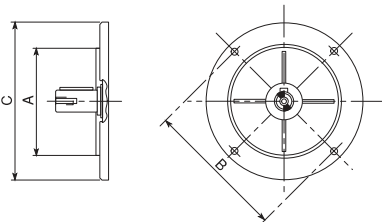

Flangia B5 maggiorata / *B5 oversize flange*  
B5 bride majoree / *Vergrößerte Flansch B5*

<b>M63</b>	AØ110 - BØ130 - CØ160
<b>M90</b>	AØ180 - BØ215 - CØ250

Flangia B5 ridotta / *B5 reduced flange*  
B5 bride reduit / *Reduzierte Flansch B5*

<b>M63</b>	AØ80 - BØ100 - CØ120
<b>M71</b>	AØ80 - BØ100 - CØ120 AØ95 - BØ115 - CØ140 *
<b>M80</b>	AØ95 - BØ115 - CØ140 AØ110 - BØ130 - CØ160 *
<b>M90</b>	AØ110 - BØ130 - CØ160 *
<b>M100</b>	AØ110 - BØ130 - CØ160 AØ130 - BØ165 - CØ200 *
<b>M112</b>	AØ130 - BØ165 - CØ200
<b>M132</b>	AØ180 - BØ215 - CØ250

### Flange speciali B14 per grandezze motori

### Possible special flange combinations B14

### Flasques speciales B14 pour taille moteur

### Mögliche spezial Flansch Kombinationen B14

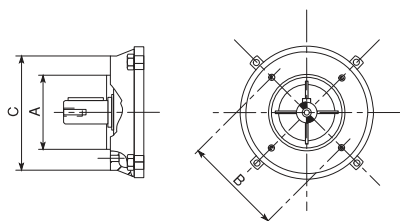

Flangia B14 maggiorata / *B14 oversize flange*  
B14 bride majoree / *Vergrößerte Flansch B14*

<b>M56</b>	AØ60 - BØ75 - CØ90 * AØ70 - BØ85 - CØ105
<b>M63</b>	AØ80 - BØ100 - CØ120 AØ70 - BØ85 - CØ105
<b>M71</b>	AØ95 - BØ115 - CØ140 * AØ80 - BØ100 - CØ120
<b>M80</b>	AØ95 - BØ115 - CØ140 AØ110 - BØ130 - CØ159 *
<b>M90</b>	AØ110 - BØ130 - CØ160 *
<b>M112</b>	AØ130 - BØ165 - CØ200

Flangia B14 ridotta / *B14 reduced flange*  
B14 bride reduit / *Reduzierte Flansch B14*

<b>M63</b>	AØ50 - BØ65 - CØ80 * AØ80 - BØ100 - CØ120
<b>M71</b>	AØ50 - BØ65 - CØ80 AØ60 - BØ75 - CØ90 *
<b>M80</b>	AØ60 - BØ75 - CØ90 AØ70 - BØ85 - CØ105 *
<b>M90</b>	AØ80 - BØ100 - CØ120 *
<b>M100</b>	AØ80 - BØ100 - CØ160 * AØ95 - BØ115 - CØ160 *
<b>M112</b>	AØ95 - BØ115 - CØ140 *
<b>M132</b>	AØ110 - BØ130 - CØ160

\* Flangia intercambiabile con quella standard

\* Flange interchangeable with standard flange

\* Courroie interchangeable avec la courroie standard

\* Anstatt der Standardflansch verwendbar

### Motori con parapioggia

### Motor with rain cover

### Moteurs avec protectione contre la pluie

### Motoren mit Regenschutzdach

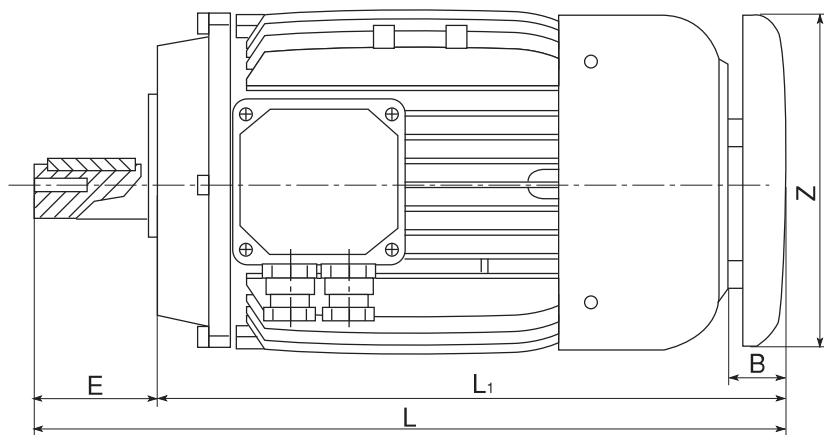

TYPE	E	L	L <sub>1</sub>	B	Z
<b>M56</b>	20	204	184	16	110
<b>M63</b>	23	238	215	22	123
<b>M71</b>	30	267	237	22	138
<b>M80</b>	40	297	257	22	156
<b>M90s</b>	50	322	272	22	176
<b>M90L</b>	50	347	297	22	176
<b>M100</b>	60	392	332	22	200
<b>M112</b>	60	410	350	25	220
<b>M132s</b>	80	490	410	30	256
<b>M132L</b>	80	520	440	30	256
<b>M160s</b>	110	635	525	35	310
<b>M160L</b>	110	679	569	35	310